

# HOW TO INSTALL

# SWG600

## Heavy Duty Bearing Hinge Set

For swinging gates weighing up to one ton.

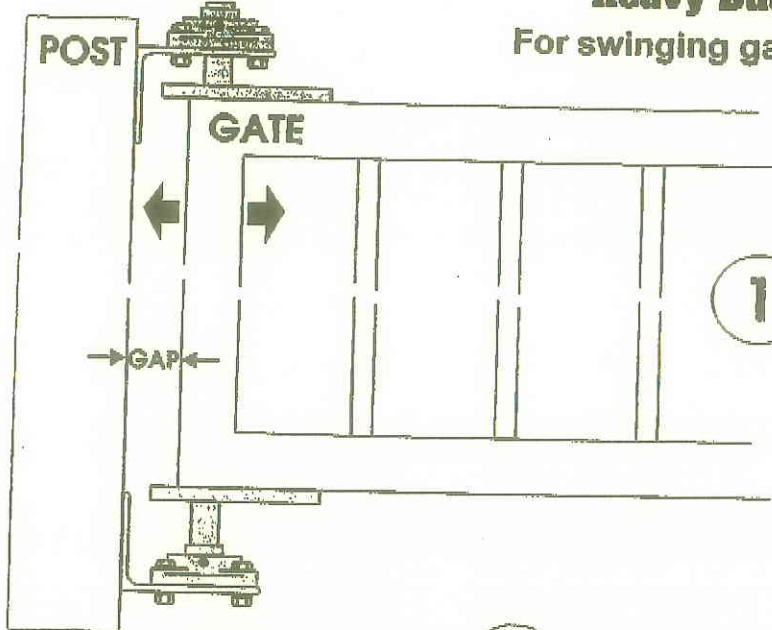

**1** Clamp hinges and gate in place. The gap may be 1 to 3 inches.

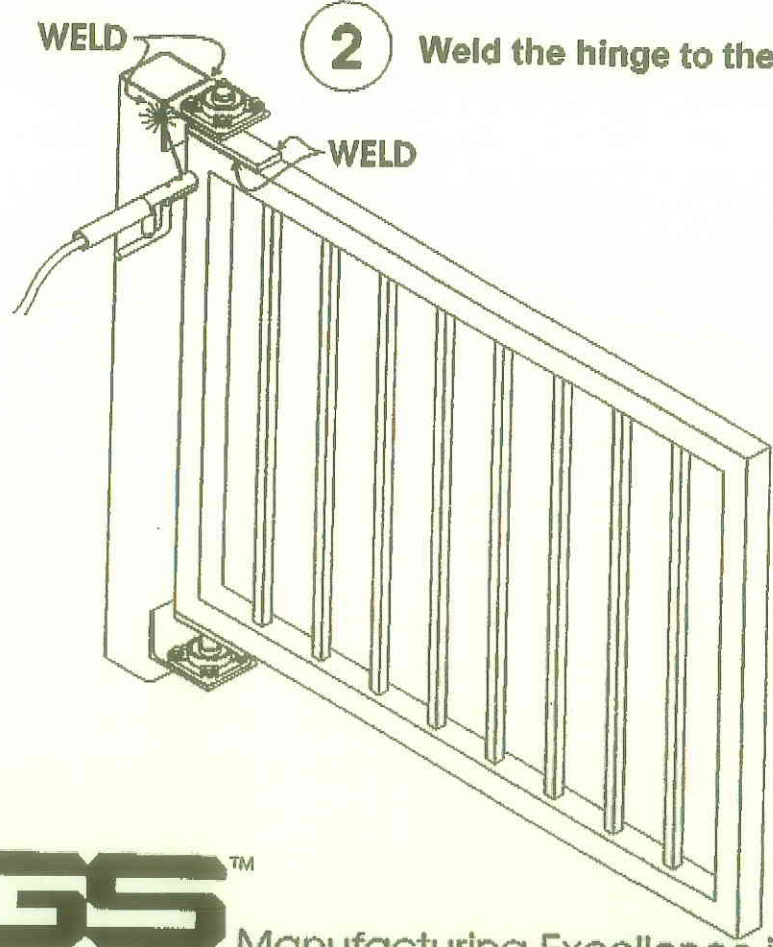

**2** Weld the hinge to the post and to the gate.



Manufacturing Excellence in Gate Automation

25563 Avenue Stanford Valencia, California 91355 • FAX 661-294-1401 • Technical Assistance 1-800-596-3114

**HINGE LOCATION DIAGRAM**

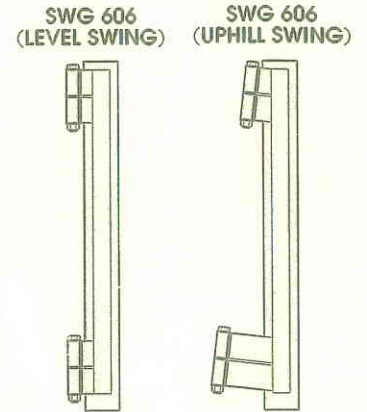
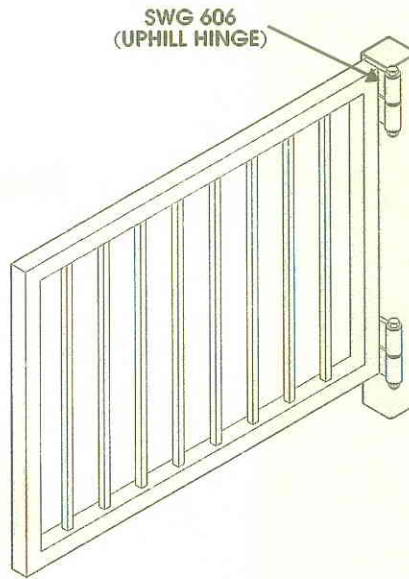
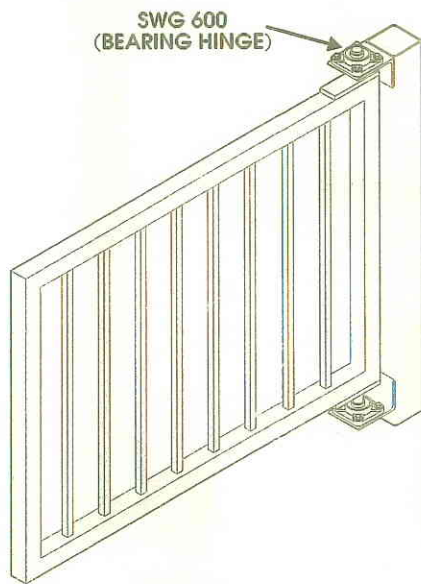

**SWG 600 Heavy Duty Bearing Hinge Set**

- 1 ton capacity per set
- Designed for continuous operation
- Steel construction
- High grade steel needle bearings
- Self aligning bearing case
- 1" diameter solid bar attachments
- Grease zerk type fitting for lubrication
- Compatible with 4" X 4" post

**SWG 606 Steel Hinge Set, For Uphill Swing or Heavy Gates**

- Handles gate up to one ton in weight per set
- For gates that swing uphill and/or for high usage and heavy gates
- 1/2" thick weldable plates
- Bronze bearings
- 3/4" diameter steel hinge bolt
- Up to 15% lift

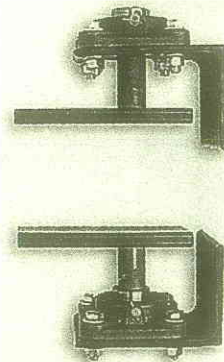

SWG 600

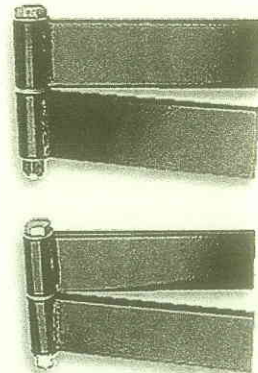
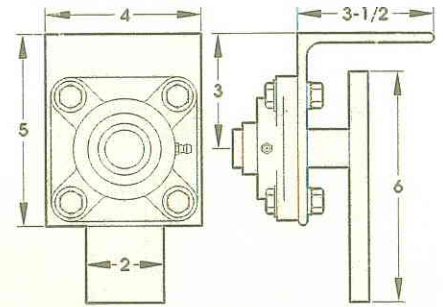

SWG 606

